

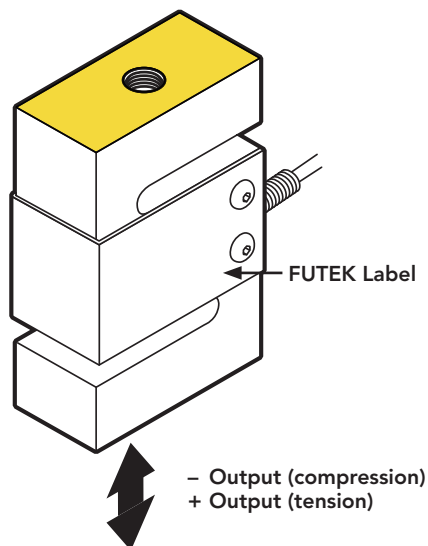

FEATURES

- For in line use in both tension and compression
- Notable nonlinearity
- Connector or robust cable strain relief

Active end



SPECIFICATIONS

PERFORMANCE

Nonlinearity	±0.1% of RO
Hysteresis	±0.05% of RO
Nonrepeatability	±0.05% of RO

ELECTRICAL

Rated Output (RO)	2 mV/V nom
Excitation (VDC or VAC)	20 max
Bridge Resistance	1000 Ohm nom
Insulation Resistance	≥500 MOhm @ 50 VDC
Connection	#28 AWG, 6 conductor, polyurethane cable, 5 ft [1.5 m] long. LEMO® connector receptacle standard
Wiring/Connector Code	CC4

MECHANICAL

Weight (approximate)	7.5 oz [212 g] (2000 lb - 18 oz [510 g])
Safe Overload	150% of RO
Deflection	0.003 to 0.010 [0.08 to 0.25] nom
Material	Anodized Aluminum (2000 lb - 17-4 PH stainless-steel)
IP Rating	IP64

TEMPERATURE

Operating Temperature	-60 to 200°F [-50 to 93°C]
Compensated Temperature	60 to 160°F [15 to 72°C]
Temperature Shift Zero	±0.001% of RO/°F [0.0018% of RO/°C]
Temperature Shift Span	±0.0008% of Load/°F [0.0014% of Load/°C]

CALIBRATION

Calibration Test Excitation	10 VDC
Calibration (standard)	5-pt Tension
Calibration (available)	Compression
Shunt Calibration Value	150 kOhm

DIMENSIONS inches [mm]

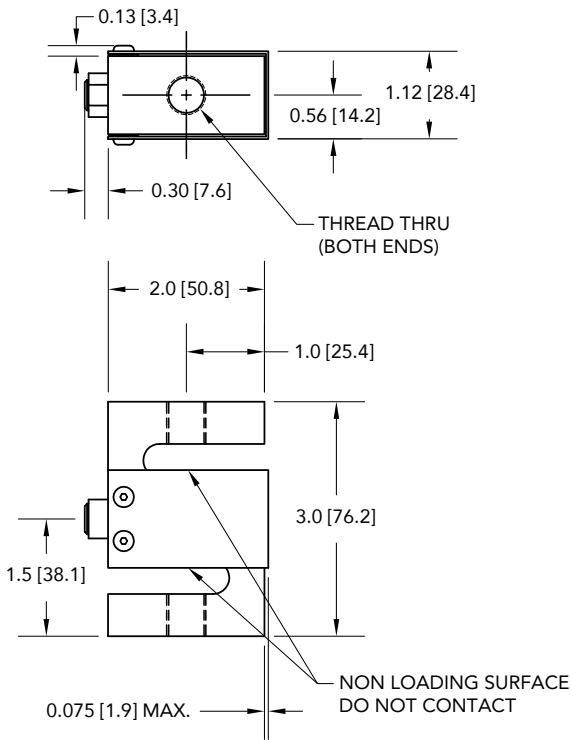

#28 AWG, 6 Conductor PU Cable (5ft) Option

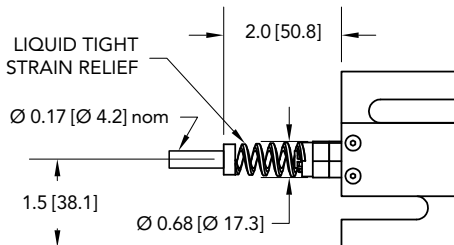

WIRING CODE (WC4)

RED	+ EXCITATION
BLACK	- EXCITATION
GREEN	+ SIGNAL
WHITE	- SIGNAL
ORANGE	+ SENSE
BLUE	- SENSE
SHIELD	GROUNDED

CAPACITIES

ITEM #	lb	N	Thread	Natural Frequency (Hz)	Deflection (in.)	Connector	
						LEMO®	Cable
FSH00967	500	2224	1/2-20	1400	0.015	X	
FSH02072						X	
FSH00966							
FSH01591			M12 x 1.75				X
FSH00971	1000	4448	1/2-20	1500	0.016	X	
FSH02070						X	
FSH00970							
FSH01592			M12 x 1.75				X
FSH00973	2000	8896	1/2-20	1300	0.011	X	
FSH02068						X	
FSH00972						X	
FSH01593			M12 x 1.75				X

CONNECTOR CODE (CC4)

PIN	WIRING CODE
1	+ EXCITATION/RED
4	- EXCITATION/BLACK
2	+ SIGNAL/GREEN
3	- SIGNAL/WHITE

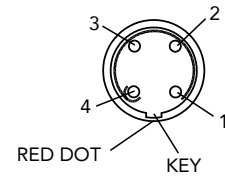

Drawing Number: FI1073-B

FUTEK reserves the right to modify its design and specifications without notice. Please visit www.futek.com/salesterms for complete terms and conditions.

10 Thomas, Irvine, CA 92618 USA

Tel: (949) 465-0900

Fax: (949) 465-0905

www.futek.com



U.S. Manufacturer